



Catalogo generale . general catalogue



MINIPRESS
DIAGNOSTIC SYSTEMS

Prevenire e' meglio che curare. Parola di Mini Press.

Mini Press e' nata nel 1991 con un obiettivo chiaro e preciso: risolvere il problema del controllo della pressione e del monitoraggio dei fluidi negli impianti oleodinamici.

Dopo una lunga esperienza nel settore, Dario Corsi, fondatore dell'Azienda, ha affrontato una delle principali cause di inefficienza del macchinario mobile: il buon funzionamento di macchine estremamente complesse e costose poteva essere ostacolato da un banale problema di riduzione o modificazione della pressione dei fluidi. La soluzione piu' ovvia, ma non per questo la piu' scontata, e' stata quella di mettere



Dario e Davide Corsi

a punto uno specifico sistema diagnostico che potesse garantire, in qualsiasi momento, luogo e condizione (anche la piu' estrema), la verifica immediata della pressione all'interno dell'impianto, senza interromperne l'attivita'. In oltre sedici anni di attivita', Mini Press, affinando e perfezionando il proprio sistema diagnostico, ha saputo raccogliere l'attenzione e il favore dei costruttori piu' accorti diventando, nel settore, uno dei principali e piu' qualificati produttori al mondo.

Il sistema Mini Press, impiantato all'origine, offre la migliore garanzia di efficienza, sicurezza e durata per tutte le macchine su cui viene installato.

Se la migliore cura e' la prevenzione, i prodotti e il sistema diagnostico di Mini Press sono un'ottima soluzione per evitare inconvenienti di funzionalita' e costosi interventi di riparazione elevando, contemporaneamente, lo standard qualitativo e prestazionale delle vostre macchine.

Prevention is better than cure. The Mini Press philosophy

Mini Press aim and mission, ever since it was founded in 1991, has been one and one only: solving the problem of pressure control and monitoring fluids inside hydraulic systems.

After a life long experience in the field, Mr Dario Corsi, the company founder, decided to tackle one of the most common causes of mobile machineries inefficiency: the proper functioning of even the most complex and expensive machines could be thwarted or hindered by a sudden and simple reduction or change in the fluid pressure. The most obvious solution to this problem, but not the simplest, was to create a specific testing system that would allow the immediate control of the pressure inside the machine, without stopping its functioning, at any moment of the working process, in any place, or under any conditions (even the most extreme)

Over the past sixteen years of activity, Mini Press has been able to establish itself as one of the major and most qualified producers of hydraulic testing equipment in the world. All of this was achieved through hard work at refining and improving its testing system, and by catching the attention and finding favour with the most attentive and significant manufacturing companies. Mini Press testing method, devised in-house, guarantees efficiency, safety and endurance for all the machines to which it is installed at construction.

If prevention is always better than cure, Mini Press products and diagnostic testing method are excellent for avoiding any future malfunctioning and expensive repairs and at the same time they can increase the quality and the performance of your machines.

Qualita', efficienza e rapidita' delle forniture.

Il nuovo "quartier generale" di Mini Press nasce e si sviluppa a Castello d'Argile, in Emilia, nel cuore della "valle dell'oleodinamica" italiana. L'organizzazione si e' qui dotata di nuove tecnologie produttive e di controllo ad altissima qualita' che, unitamente all'esperienza maturata nel tempo, le permettono di offrire un prodotto e un servizio apprezzati in tutto il mondo.

La soddisfazione del cliente e' da sempre, il nostro obiettivo primario. E' per questo motivo che oggi, chiunque ci conosca, sa che Mini Press non e' solo un ottimo produttore di sistemi diagnostici ma, soprattutto e'un vero e proprio partner commerciale di cui ci si puo', sempre e comunque, fidare.

Quality, efficiency and speed in supplying.

Mini Press new "headquarters" are based in Castello d'Argile, in the Emilia region, the heart of the Italian "hydraulic valley". The new location is equipped with the latest technologies for production and the highest quality control. All of this, along with the experience gained over the years, enables Mini Press to offer products and service valued worldwide. Customer's satisfaction has always been our main aim and whoever knows us is well aware that not only are we excellent producers of pressure testing systems but above all Mini Press is a true business partner, on whom one can always rely on.



"Rapid System", il piu' perfetto sistema di diagnostica per impianti oleodinamici.

Con tutta l'esperienza e il know-how di cui dispone, Mini Press ha messo a punto "Rapid System", una gamma completa di componenti miniaturizzati che consentono di monitorare ogni singolo sistema, localizzando tempestivamente il problema e impedendo l'insorgenza di altre complicazioni. "Rapid System" puo' essere utilizzato nelle fasi di collaudo, nelle operazioni di spurgo, di prelievo di campioni di fluido, nella manutenzione e nell'assistenza senza interrompere l'attivita' dell'impianto. Il sistema, riducendo notevolmente gli interventi sulle macchine, permette un considerevole risparmio di tempo e risorse, aumentando nel contempo la sicurezza per l'utilizzatore finale. "Rapid System" è l'unica soluzione che, al momento, permette un controllo realmente affidabile degli impianti oleodinamici, incrementando il valore intrinseco delle macchine su cui viene installato.

"Rapid System", the most perfect diagnostic system for hydraulic plants.

With all its experience and know-how, Mini Press created and finely tuned "Rapid System", a complete range of miniaturized components which allow a constant monitoring and immediate control on any hydraulic equipment. By localizing immediately any problem in the system it avoids any further complications. "Rapid System" can be used at any time during the phases of testing, bleeding, fluid sampling, maintenance and assistance, without stopping the functioning of the plant. Thus reducing the amount of time and resources spent on servicing the machines, and at the same time further insures the operators' safety.

"Rapid System" is the only solution that enables a reliable and effective control of hydraulics plants and at the same time increases the intrinsic value of the machine to which it is installed

A disposizione di un mondo di costruttori.

I prodotti e i sistemi Mini Press possono essere applicati a qualsiasi tipo di macchinario mobile. Una fitta rete di rivenditori puo' garantire la fornitura alle Aziende costruttrici di tutti i principali settori (agricolo, industriale, edile e dei trasporti) e in tutti i Paesi del mondo. L'incredibile rapporto costo/benefici dei prodotti Mini Press puo' mettere qualsiasi costruttore nelle condizioni di elevare notevolmente gli standard qualitativi e di sicurezza delle proprie macchine.

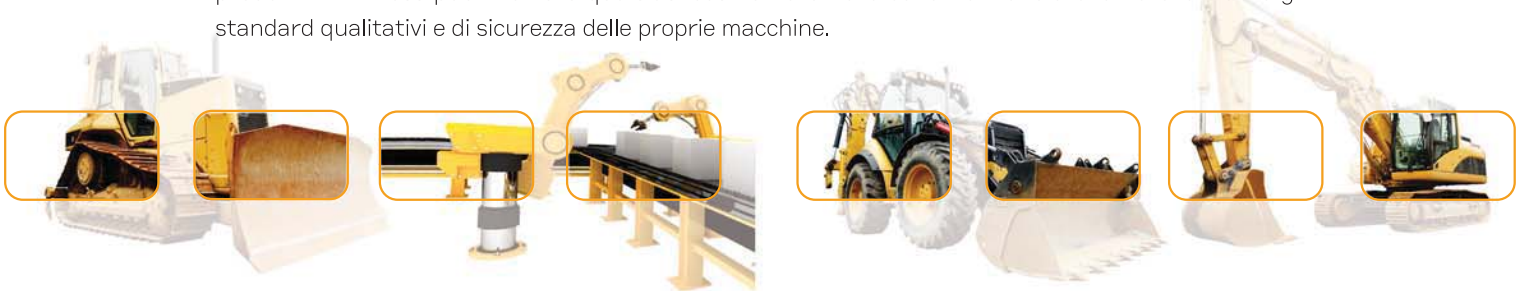

At the Manufacturer's service.

Mini Press products and systems can be applied to any type of mobile machine. With our comprehensive distribution network, we can supply everywhere in the world, in all the main sectors: agricultural, industrial, building construction or transport and in each sector the manufacturer can increase the quality and safety of their machines, thanks to the amazing cost/benefits ratio of our produc

I nostri prodotti . Our products



Miniprese prova pressione

Test coupling for pressure control



Rubinetti esclusori per protezione manometro

Anti-shock valves for gauges protection



Manometri

Gauges



Tubo capillare alta pressione e raccordi

High pressure micro-hose and fittings



Strumenti portatili prova pressione

Portable pressure test kits



Misuratori di portata in linea

High pressure in-line flow indicators

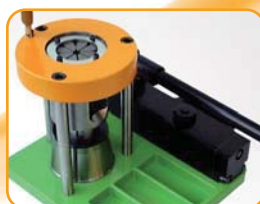

Pressa oleodinamica portatile

Portable hydraulic crimping machine

Mini Press nel mondo

Minipress fornisce ed assiste i propri clienti, direttamente o attraverso concessionari di fiducia, nei principali mercati a livello mondiale:

Argentina, Australia, Austria, Belgio, Bulgaria, Cile, Cina, Danimarca, Dubai, Egitto, Francia, Germania, Gran Bretagna, Grecia, India, Irlanda, Islanda, Israele, Libano, Nuova Zelanda, Olanda, Polonia, Portogallo, Rep. Ceca, Romania, Russia, Scandinavia, Slovacchia, Slovenia, Spagna, Stati Uniti, Sud Africa, Svizzera, Tunisia, Turchia.

Mini Press Worldwide

Mini Press supply products and assistance to its customers in the main markets around the World, directly or through appointed agents and distributors:

Argentina, Australia, Austria, Belgium, Bulgaria, Chile, Czech Republic, Denmark, Dubai, Egypt, France, Germany, Great Britain, Greece, Holland, Iceland, India, Ireland, Israel, Lebanon, New Zealand, Poland, Portugal, Romania, Russia, Scandinavia, Slovakia, Slovenia, Spain, South Africa, Switzerland, U.S.A, Tunisia, Turkey.



MINIPRESS
DIAGNOSTIC SYSTEMS

- 2 ▶ **Miniprese prova pressione**
Test couplings for pressure checking



- 16 ▶ **Tubo capillare per alta pressione e raccordi**
Micro hose for high pressure and fittings



- 35 ▶ **Strumenti portatili prova pressione**
Portable Hydraulic instruments for pressure testing



- 37 ▶ **Manometri**
Pressure gauges



- 38 ▶ **Rubinetti sclosori protezione manometro**
Pressure gauge anti-shock valves



- 40 ▶ **Misuratori di portata in linea**
In-line flow indicators



- 41 ▶ **Pressa oleodinamica portatile**
Portable hydraulic crimping machine



Applicazioni:

- Controllo pressione
- Lubrificazione
- Spurgo aria
- Prelievo campioni olio

Materiale:

Acciaio al carbonio zincato
(Acciaio inox AISI 316, disponibile su richiesta)

Guarnizioni:

NITRILE BUNA N (NBR)
(VITON, disponibili su richiesta)
Temperatura di esercizio:
-30°C...+125°C (NITRILE)
-25°C...+230°C (FKM)

Fluidi:

Olio idraulico
Olio a base minerale
Compatibilità con altri fluidi a richiesta

Applications:

- Pressure control
- Lubrication
- Air bleeding
- Oil sampling

Materials:

Galvanised carbon steel
(Stainless steel AISI 316 is available on request)

Sealing:

NITRILE BUNA N (NBR)
FKM – VITON (on request)
Working temperature:
-30°C...+125°C (NITRILE BUNA N)
-25°C...+230°C (FKM)

Fluids:

Hydraulic oils
Mineral oils
Suitability with other fluids on request

Esecuzione dei fori filettati e tipi di tenuta
Hole screw-cuts and sealing types

Type **A**

Tenuta con O-Ring O-Ring sealing	G	D	L	L1
M 8x1		9.5	11	15.5
M 10x1		11.5	12	16.5
M 10x1.25		11	12	16.5
M 14x1.5		15.8	12	18

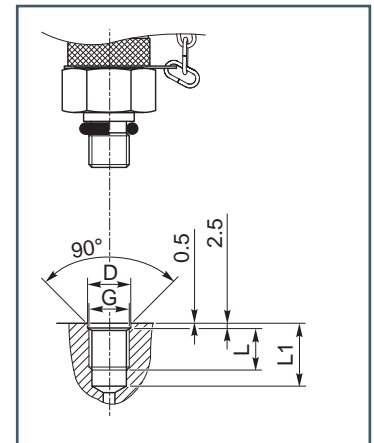
Type **B**

Tenuta con spigolo metallico di incisione Metal sealing edge	G	D	L	L1	S
M 10x1		15	10	13.5	1
M 12x1.5		18	12	18.5	1
M 14x1.5		20	14	18.5	1
M 16x1.5		22	14	18.5	1.5
ISO 228 G 1/8"		15	10	13.5	1
ISO 228 G 1/4"		19	14	18.5	1
ISO 228 G 3/8"		24	16	18.5	1.5

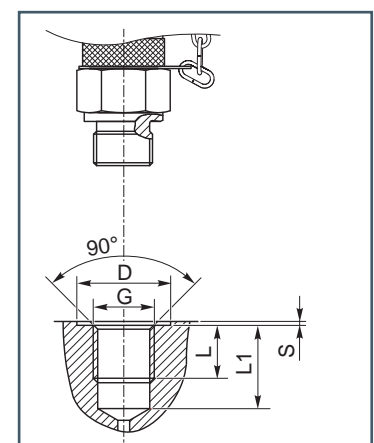



Type

Tenuta con guarnizione piana
Flat gasket sealing

C

G	D	L	L1	S
M 10x1	17	10	13.5	1
M 12x1.5	18	12	18.5	1
M 14x1.5	20	14	18.5	1
M 16x1.5	22	14	18.5	1.5
ISO 228 G 1/8"	17	10	13.5	1
ISO 228 G 1/4"	20	14	18.5	1
ISO 228 G 3/8"	24	16	18.5	1.5
ISO 228 G 1/2"	30	18	24	1.5

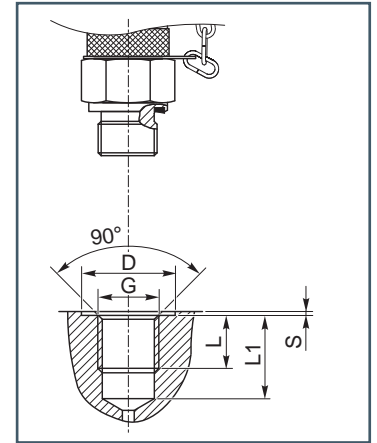

Type **D**

Tenuta:
- Gas conico ISO 7/1
- Conico NPTF

Sealing by thread:
- B.S.P. Taper ISO 7/1
- Taper NPTF

G	L	L1
ISO 7/1 1/8"	5.5	12
ISO 7/1 1/4"	8.5	13.5
ISO 7/1 3/8"	12	20
1/8"-27 NPTF	9	14
1/4"-18 NPTF	9	18.5
3/8"-18 NPTF	14	20

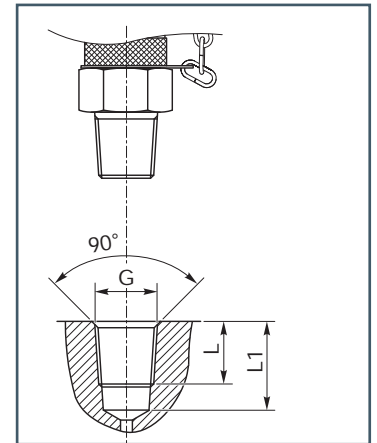

Type **E**

Tenuta con guarnizione UNF
UNF O-Ring sealing

G	d	D	L	L1	S	a
7/16"-20 UNF	12.4	17	11.5	14	2.4	1.6
1/2"-20 UNF	14	18	11.5	14	2.4	1.6
9/16"-18 UNF	15.6	20	12.7	15.5	2.5	1.6
3/4"-16 UNF	20.5	25	16	20	2.6	2.4

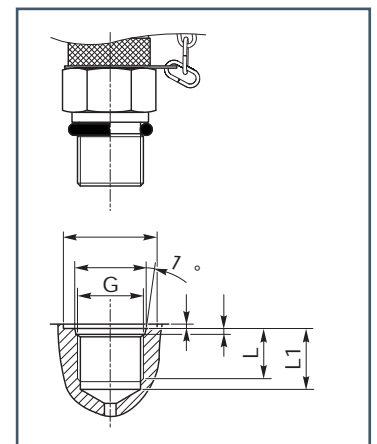



Come ordinare

How to order

Per ordinare i componenti indicare il codice riportato nelle tabelle per ogni configurazione indicando l'eventuale lettera attribuita all'opzione desiderata.

Please indicate the code shown in the required form chart, and add, if necessary, the letter of the chosen option.

Configurazione / Form

Tappo metallo con catenella e sistema di tenuta a sfera
Metal cap with chain and ball sealing system

Lettera "C" nel codice / "C" in the ref. xxxxxxxC

Tappo metallo con catenella e sistema di tenuta a pistone
Metal cap with chain and poppet valve sealing system

Anteporre "S1" al codice / Put "S1" in front of the ref. number S1xxxxxxxC

Opzioni / Options



O

Tappo metallo. laccio in plastica / Metal cap with plastic binder

Sostituire nel codice "C" con "O" / Replace "C" with "O" xxxxxxxO

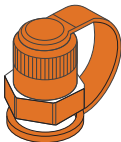

P

Tappo in plastica / Plastic cap

Sostituire nel codice "C" con "P" / Replace "C" with "P" xxxxxxxP

Miniprese filettate M16x2

Threaded test couplings M16x2

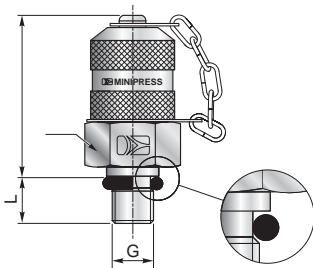

G	H	L	Ch	PN [bar]	Tenuta/Seal	Codice/Ref.
Metrica cilindrica / Metric parallel						
M8x1	37	8.5	17	250	O-Ring type A	0108X10C
M10x1	37	8.5	17	630		0110X10C
M10x1.25	37	9	17	630		0110X12C
M14x1.5	37	10	19	630		0114X15C
Metrica cilindrica / Metric parallel						
7/16"-20UNF	37	9	17	630	O-Ring type E	0171X20C
1/2"-20UNF	37	10	17	630		0112X20C
9/16"-18UNF	37	10	19	630		0191X18C
3/4"-16UNF	37	14	22	630		0134X16C

Opzioni/Options

O

P



Miniprese filettate M16x2

Threaded test couplings M16x2

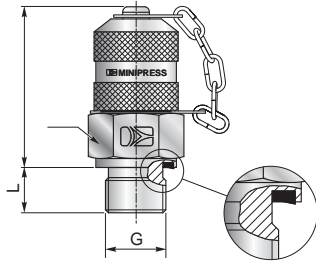

G	H	L	Ch	PN [bar]	Tenuta/Seal	Codice/Ref.
<i>Metrica cilindrica / Metric parallel</i>						
M 10x1	37	8	17	630	Type C	0410X10C
M 12x1.5	37	10	17	630		0612X15C
M 14x1.5	37	12	19	630		0614X15C
M 16x1.5	37	12	22	630		0616X15C
<i>Gas cilindrica / B.S.P. parallel</i>						
ISO 228 G 1/8"	37	8	17	630	Type C	0718G00C
ISO 228 G 1/4"	37	12	19	630		0714G00C
ISO 228 G 1/4" *	37	12	19	630		0714G0AI
ISO 228 G 3/8"	37	14	22	630		0738G00C
ISO 228 G 1/2"	37	15	27	630		0712G00C

* INOX / Stainless steel

Opzioni/Options

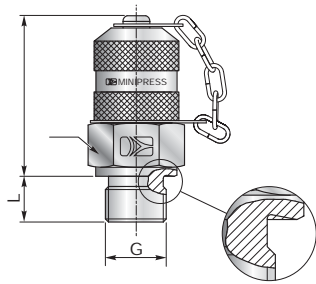

G	H	L	Ch	PN [bar]	Tenuta/Seal	Codice/Ref.
<i>Metrica cilindrica / Metric parallel</i>						
M 10X1	37	8.5	17	400	Type B	0310X10C
M 12X1.5	37	12	17	630		0312X15C
M 14X 1.5	37	12	19	630		0314X15C
M 16X1.5	37	12	22	630		0316X15C
<i>Gas cilindrica / B.S.P. parallel - Forma B / Form B</i>						
ISO 228 G 1/8"	37	8	17	400	Type B	0418G00C
ISO 228 G 1/4"	37	12	19	630		0414G00C
ISO 228 G 3/8"	37	14	22	630		0438G00C

Opzioni/Options

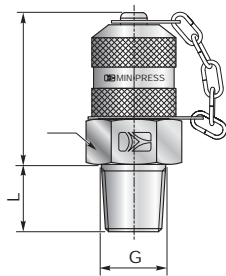

G	H	L	Ch	PN [bar]	Tenuta/Seal	Codice/Ref.
<i>GAS conica / B.S.P taper</i>						
ISO 7/1 R 1/8"	37	10	17	400	Type D	0818280C
ISO 7/1 R 1/4"	37	12	19	630		0814190C
ISO 7/1 R 3/8"	37	14	22	630		0838190C
<i>NPTF / NPTF</i>						
1/8"-27 NPTF	37	10	17	400	Type D	0918270C
1/4"-18 NPTF	37	14	19	630		0914180C
1/4"-18 NPT*	37	14	19	630		091418AI
3/8"-18 NPTF	37	16	22	630		0938180C

* INOX / Stainless steel

Opzioni/Options





Minipresa a codolo liscio

Threaded test couplings

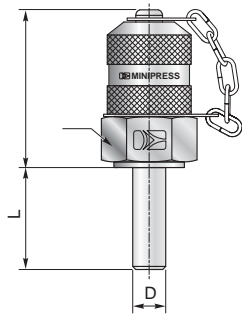

D	H	L	Ch	PN [bar]		Codice/Ref.
				Series L	Series S	
6	37	20	17	315	630	1206000C
6	37	20	17	315	630	1206A100
8	37	20	17	315	630	1208000C
10	37	20	17	315	630	1210000C
12	37	20	17	315	630	1212000C
14	37	20	17	—	630	1214000C
15	37	20	17	315	—	1215000C
16	37	20	17	—	400	1216000C

INOX / Stainless steel

Opzioni/Options

O P

Minipresa passaparete

Bulkhead test coupling

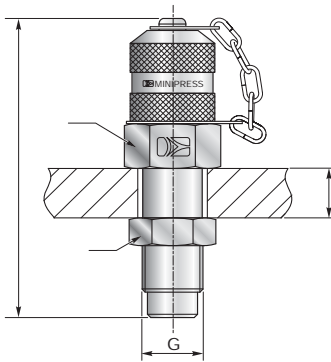

G	H	Ch	S max	PN [bar]	Codice/Ref.
M 16x2	80	19	25	630	22PP000C

Opzioni/Options

O P

Minipresa passaparete per tubo metallico

Bulkhead test coupling for metal pipe fitting

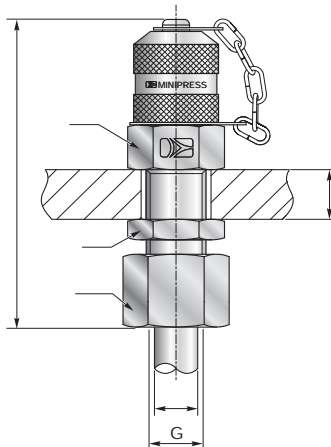

Serie / Series	D	G	H	Ch	Ch 1	S max	PN [bar]	Codice/Ref.
S	8	M 16x1.5	80	19	19	20	630	1616X15C
	10	M 18x1.5	82	22	22	20	630	1618X15C
	12	M 20x1.5	84	24	24	20	630	1620X15C

Opzioni/Options

O P



Minipresa raccordo intermedio diretto per tubo metallico
Straight test coupling for metal pipe fitting

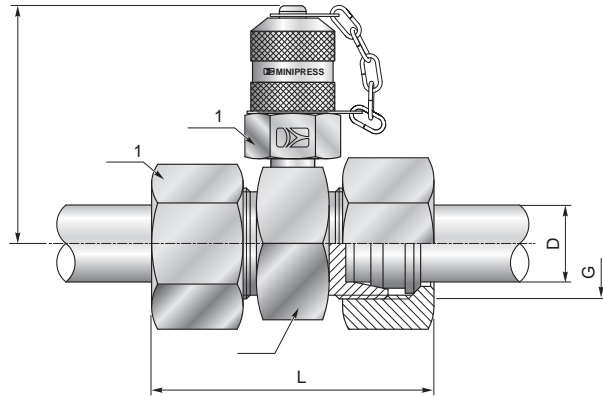

Serie / Series	D	G	H	L	Ch 1	Ch 2	S max	PN [bar]	Codice/Ref.
Raccordi ad anello / Ring fittings									
L	6	M 12x1.5	49	51	51	14	24	315	1306000C
	8	M 14x1.5	49	51	51	17	24	315	1308000C
	10	M 16x1.5	49	53	53	19	24	315	1310000C
	12	M 18x1.5	49	53	53	22	24	315	1312000C
	15	M 22x1.5	50.5	55	55	27	27	315	1315000C
	18	M 26x1.5	53	57	57	32	32	315	1318000C
	22	M 30x2	53	61	61	36	32	160	1322000C
	28	M 36x2	57.5	61	61	41	41	160	1328000C
	35	M 45x2	60	69	69	50	46	160	1335000C
42	M 52x2	64.5	71	71	60	55	160	1342000C	
S	6	M 14x1.5	49	55	55	17	24	630	1406000C
	8	M 16x1.5	49	55	55	19	24	630	1408000C
	10	M 18x1.5	49	57	57	22	24	630	1410000C
	12	M 20x1.5	49	57	57	24	24	630	1412000C
	14	M 22x1.5	49	63	63	27	24	630	1414000C
	16	M 24x1.5	52	63	63	30	27	400	1416000C
	20	M 30x2	53	69	69	36	32	400	1420000C
	25	M 36x2	57.5	75	75	46	41	400	1425000C
	30	M 42x2	60	81	81	50	46	400	1430000C
38	M 52x2	64.5	89	89	60	55	315	1438000C	

Opzioni/Options





Minipresa tipo DKO codolo conico 24° con O-Ring

Test coupling with 24° O-Ring sealing cone DKO type

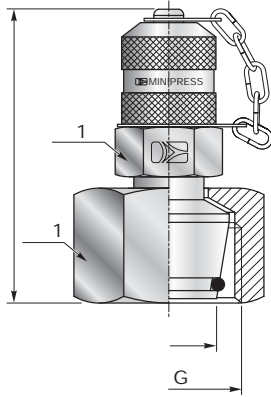

Serie / Series	D	G	H	Ch 1	PN [bar]	Codice/Ref.
L	6	M 12x1.5	54	14	315	1012X15C
	8	M 14x1.5	54	17	315	1014X15C
	10	M 16x1.5	59	19	315	1016X15C
	12	M 18x1.5	59	22	315	1018X15C
	15	M 22x1.5	59	27	315	1022X15C
	18	M 26x1.5	59	32	315	1026X15C
	22	M 30x2	59	36	160	1030X20C
	28	M 36x2	60	41	160	1035X20C
	35	M 45x2	62	50	160	1045X20C
	42	M 52x2	65	60	160	1052X20C
S	6	M 14x1.5	54	17	630	1114X15C
	8	M 16x1.5	54	19	630	1116X15C
	10	M 18x1.5	59	22	630	1118X15C
	12	M 20x1.5	59	24	630	1120X15C
	14	M 22x1.5	59	27	630	1122X15C
	16	M 24x1.5	60	30	400	1124X15C
	20	M 30x2	62	36	400	1130X20C
	25	M 36x2	65	46	400	1136X20C
	30	M 42x2	65	50	400	1142X20C
	38	M 52x2	65	60	315	1152X20C

Opzioni/Options



Minipresa di pressione con giunzione diretta 60°

Check coupling male - female swivel 60°

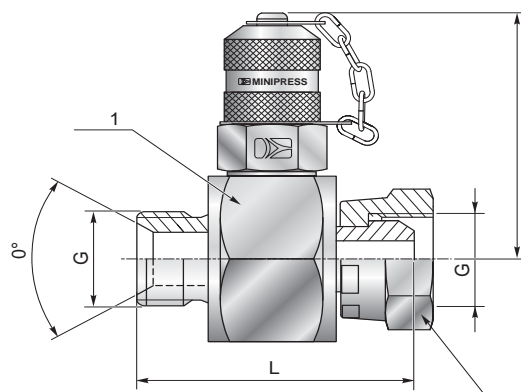

G	H	L	Ch1	Ch2	PN bar	Codice/Ref.
ISO 228 G1/4"	55	53	32	19	400	1914G00C
ISO 228 G3/8"	55	60	32	22	400	1938G00C
ISO 228 G1/2"	55	60	32	27	400	1912G00C
ISO 228 G3/4"	55	68	32	32	400	1934G00C
ISO 228 G1"	60	74	41	41	315	1901G00C

Opzioni/Options





Minipresa passaparte JIC 37°

Bulkhead test coupling - JIC 37°

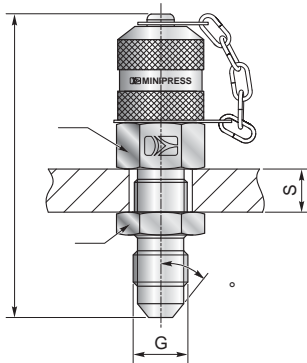

G	H	Ch	S max	PN [bar]	Codice/Ref.
7/16"-20 UNF	68	17	9	630	1707162C
1/2"-20 UNF	68	17	9	400	1701220C
9/16"-18 UNF	69	19	9	315	1709161C

Opzioni/Options



Minipresa con raccordo femmina girevole sede JIC 37°

Female swivel test coupling - JIC 37°

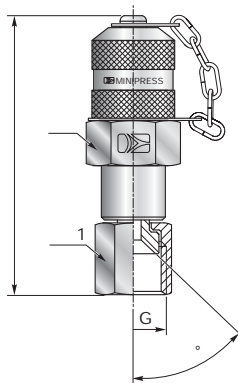

G	H	Ch	Ch 1	PN [bar]	Codice/Ref.
7/16"-20 UNF	64	17	14	630	1507163C
1/2"-20 UNF	65	17	17	400	1512203C
9/16"-18 UNF	67	17	19	315	1509163C
3/4"-16 UNF	70	17	22	315	1506163C

Opzioni/Options



Minipresa con raccordo femmina fisso sede JIC 37°

Female fixed test coupling - JIC 37°

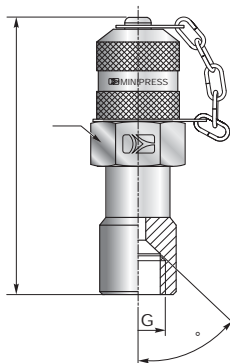

G	H	Ch	PN [bar]	Codice/Ref.
7/16"-20 UNF	63	17	630	15071FFC
1/2"-20 UNF	63	17	400	15012FFC
9/16"-18 UNF	66	19	315	15091FFC

Opzioni/Options





Minipresa con raccordo femmina girevole O.R.F.S.

O.R.F.S female swivel test coupling

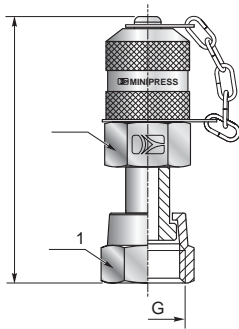

G	H	Ch	Ch 1	PN [bar]	Codice/Ref.
9/16"-18 UNF	53	17	19	400	15916FSC
11/16"-16 UNF	54	17	22	400	15116FSC
13/16"-16 UNF	58	19	24	400	15131FSC

Opzioni/Options



Minipresa di pressione femmina girevole

Female swivel check-coupling

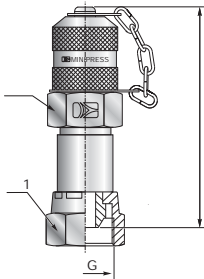

G	H	Ch	Ch 1	PN [bar]	Codice/Ref.
ISO 228 G 1/4"	62	19	19	630	15914G0C

Opzioni/Options





Miniprese con innesto a baionetta

Plug-in test couplings

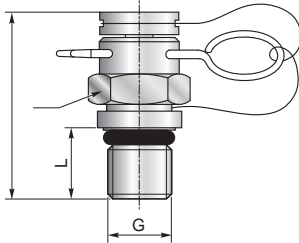

G	H	L	Ch	PN [bar]	Tenuta/Seal	Codice/Ref.
Filettatura: metrica cilindrica / Threaded: metric parallel (UNI 4535-64)						
M 8x1	25	8.5	12	250	O-Ring type A	5100000
M 10x1	25	8.7	14	400		5110000

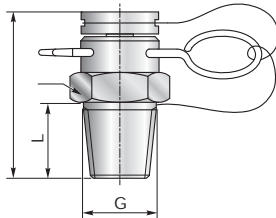

G	H	L	Ch	PN [bar]	Tenuta/Seal	Codice/Ref.
Filettatura: gas conica / Threaded: B.S.P. taper (UNI ISO 7/1)						
ISO 7/1 R1/8"	25	12	12	400	Type D	5180000
Filettatura: gas conica / Threaded: B.S.P. taper NPTF (ANSI/ASME B.1.20.1 - 1983)						
1/8" NPTF	25	12	12	400	Type D	5190000

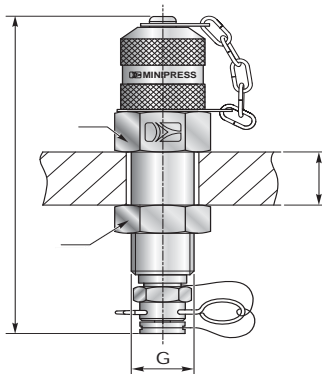

G	H	Ch	S max	PN [bar]	Codice/Ref.	
Minipresa passaparete / Bulkhead test coupling						
M 16x2	90	19	25	400	23PPIB0C	
Opzioni/Options					0	P



Minipresa con innesto a baionetta tipo DKO codolo conico 24° con O-Ring

Plug-in test coupling with 24° O-Ring sealing cone DKO type

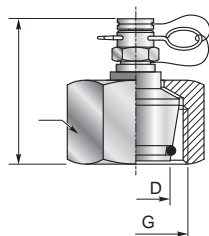

Serie / Series	D	G	H	Ch	PN [bar]	Codice/Ref.
L	10	M 16x1.5	39	19	315	1016X15B
	12	M 18x1.5	39	22	315	1018X15B
	15	M 22x1.5	39	27	315	1022X15B
	18	M 26x1.5	39	32	315	1026X15B
	22	M 30x2	39	36	160	1030X20B
	28	M 36x2	40	41	160	1035X20B
	35	M 45x2	42	50	160	1045X20B
	42	M 52x2	45	60	160	1052X20B
S	10	M 18x1.5	39	22	630	1118X15B
	12	M 20x1.5	39	24	630	1120X15B
	14	M 22x1.5	39	27	630	1122X15B
	16	M 24x1.5	40	30	400	1124X15B
	20	M 30x2	42	36	400	1130X20B
	25	M 36x2	44	46	400	1136X20B
	30	M 42x2	44	50	400	1142X20B
	38	M 52x2	44	60	315	1152X20B

Minipresa a baionetta raccordo intermedio diritto per tubo metallico

Plug-in straight test coupling for metal pipe fitting

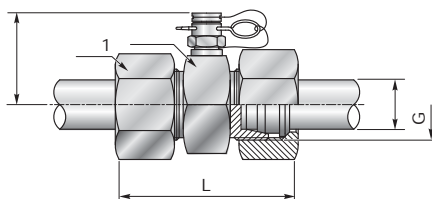

Serie / Series	D	G	H	L	Ch 1	Ch 2	PN [bar]	Codice/Ref.
Raccordi ad anello / Ring fittings								
L	6	M 12x1.5	29	51	14	24	315	1306000B
	8	M 14x1.5	29	51	17	24	315	1308000B
	10	M 16x1.5	29	53	19	24	315	1310000B
	12	M 18x1.5	29	53	22	24	315	1312000B
	15	M 22x1.5	30.5	55	27	27	315	1315000B
	18	M 26x1.5	33	57	32	32	315	1318000B
	22	M 30x2	33	61	36	32	160	1322000B
	28	M 36x2	37.5	61	41	41	160	1328000B
	35	M 45x2	40	69	50	46	160	1335000B
	42	M 52x2	44.5	71	60	55	160	1342000B
S	6	M 14x1.5	29	55	17	24	630	1406000B
	8	M 16x1.5	29	55	19	24	630	1408000B
	10	M 18x1.5	29	57	22	24	630	1410000B
	12	M 20x1.5	29	57	24	24	630	1412000B
	14	M 22x1.5	29	63	27	24	630	1414000B
	16	M 24x1.5	32	63	30	27	400	1416000B
	20	M 30x2	33	69	36	32	400	1420000B
	25	M 36x2	37.5	75	46	41	400	1425000B
	30	M 42x2	40	81	50	46	400	1430000B
	38	M 52x2	44.5	89	60	55	315	1438000B



Miniprese filettate M16x1.5
Threaded test couplings M16x1.5

M16x1.5

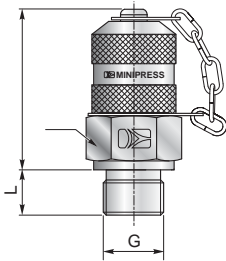

G	H	L	Ch	PN [bar]	Tenuta/Seal	Codice/Ref.
<i>Metrica cilindrica / Metric parallel</i>						
M 8x1	37	8.5	17	250	Type	0108150C
M 10x1	37	8.5	17	630	A	0110150C
<i>Gas cilindrica / B.S.P. parallel</i>						
ISO 228 G 1/4"	37	8	17	630	Type	0714150C
					C	

Miniprese filettate M12.65x1.5
Threaded test couplings M12.65x1.5

M12.65x1.5

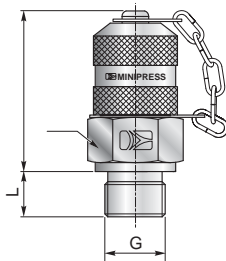

G	H	L	Ch	PN [bar]	Tenuta/Seal	Codice/Ref.
<i>Metrica cilindrica / Metric parallel</i>						
M 8x1	30	8.5	14	250	Type	0108120C
M 10x1	30	8.5	14	630	A	0110120C
<i>Gas cilindrica / B.S.P. parallel</i>						
ISO 228 G 1/4"	29	8	19	630	Type	0714120C
					C	



Adattatori per manometro
Pressure gauge adapters

Come ordinare
How to order

Configurazione / Configuration

Il codice degli adattatori termina sempre con 0
Adapters code ends with 0 xxxxxxx0

Opzioni / Options

Smorzatore di pressione a richiesta / Pressure damper on request

S Sostituire la lettera S allo 0
Replace "0" with "S" xxxxxxxS

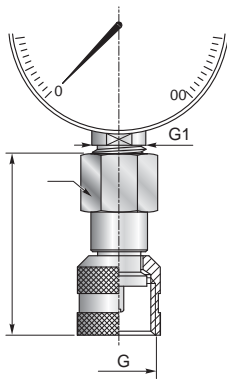

G	G1	H	Ch	Ch 1	PN [bar]	Codice/Ref.
Porta manometro connessione diretta / Direct gauge adapter						
M 16x2	ISO 228 G 1/4"	50	19	19	630	20140000
M 16x2	ISO 228 G 1/2"	55	27	19	630	20120000
M 16x1.5	ISO 228 G 1/4"	50	19	19	630	20141500
M 16x1.5	ISO 228 G 1/2"	55	27	19	630	20121500

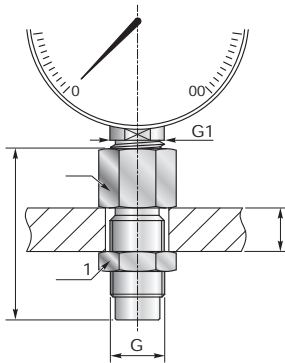

G	G1	H	Ch	Ch 1	S max	PN [bar]	Codice/Ref.
Porta manometro passaparete / Bulkhead pressure gauge connection							
M 16x2	ISO 228 G 1/4"	50	19	19	11	630	18140000
M 16x2	ISO 228 G 1/2"	57	27	19	13	630	18120000
M 16x1.5	ISO 228 G 1/4"	50	19	19	11	630	18141500
M 16x1.5	ISO 228 G 1/2"	57	27	19	13	630	18121500

N.B. : passaggio libero senza valvola / Note: without check valve

Opzioni/Options **S**

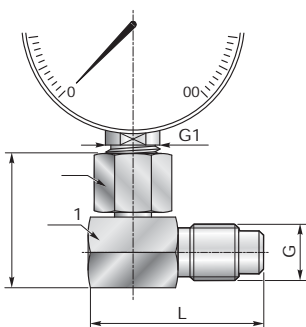

G	G1	H	L	Ch	Ch 1	PN [bar]	Codice/Ref.
Porta manometro orientabile 90° / Swivel pressure gauge connection 90° angle							
M 16x2	ISO 228 G 1/4"	36	42	19	19	630	21140000
M 16x2	ISO 228 G 1/2"	43	42	27	19	630	21120000
M 16x1.5	ISO 228 G 1/4"	36	42	19	19	630	21141500
M 16x1.5	ISO 228 G 1/2"	43	42	27	19	630	21121500

N.B. : passaggio libero senza valvola / Note: without check valve

Opzioni/Options **S**



Adattatori
Adapters

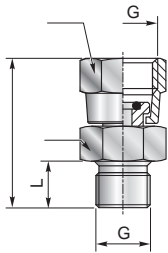

G	H	L	Ch	PN [bar]	Tenuta/Seal	Codice/Ref.
Connettore porta manometro orientabile / Swivel pressure gauge connection						
ISO 228 G 1/4"	34	11	17	400	*	1814M000
ISO 228 G 1/2"	46	15	27	400	*	1812M000

* Rondella di rame (a richiesta) / Copper washer (on request)

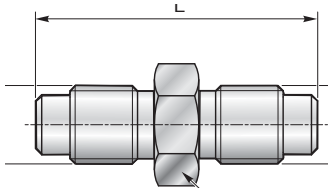

G	L	Ch	PN [bar]	Codice/Ref.
Adattatore diretto per giunzione tubi. Passaggio libero Straight adapter for connection of hoses. Free flow.				
M 16x2	43	17	630	40GD0000

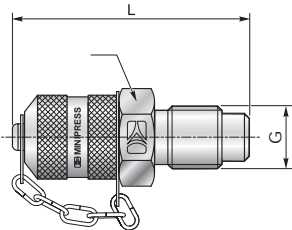

G	L	Ch	PN [bar]	Codice/Ref.
Adattatore diretto con valvola di non ritorno / Straight adapter with no-return valve				
M 16x2	53	17	630	41GV000C

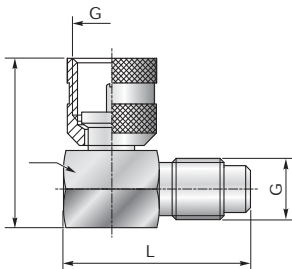

G	H	L	Ch	PN [bar]	Codice/Ref.
Adattatore giunzione 90° orientabile / 90° Swivel adapter					
M 16x2	42	41	19	630	24GG0000
M 16x1.5	42	41	19	630	24GG1500



Come ordinare

How to order

Esempio per l'ordine
 Ordering example

Codice ordine / Order code					
RD2	31TN	0	3614	0	L1500
1	2	3	4	5	6

- 1 Tubo / Hose type
- 2 Tipo raccordo / Fitting type
- 3 Curvatura del raccordo
Elbow fitting angle
- 4 Tipo raccordo / Fitting type
- 5 Curvatura del raccordo
Elbow fitting angle
- 6 Lung. tubo / Hose length

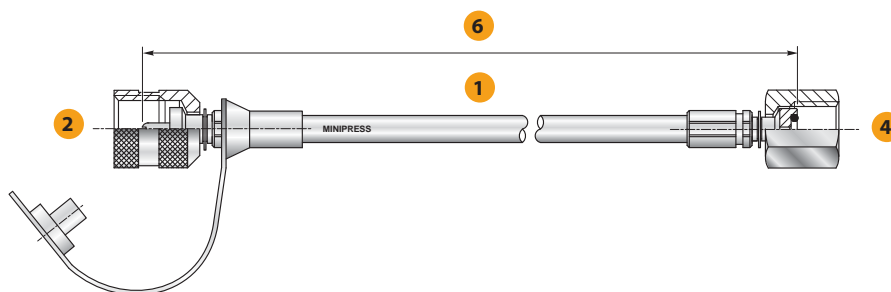
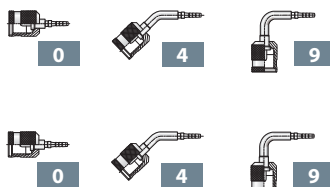

Normativa di riferimento

Reference regulations

Riferimento tubo / Hose code				
RD2 - RD3 - RD4				
Adatto per passaggio di oli minerali, oli idraulici tipo ASTM 3, benzine. resistenza chimica all'olio per freni (tipo DOT 4) For mineral and hydraulic oil. type ASTM 3. fuel. brake sy-stems oil (type DOT 4)				
		RD2	RD3	RD4
Diam esterno Outside diameter	[mm]	5	6	8
Diametro interno Inside diameter	[mm]	2	3	4
Pressione max. di lavoro Max. working pressure	[bar]	630	630	500
Pressione minima di scoppio Min. Bursting pressure	[bar]	1890	1890	1500
Raggio minimo Min. Bending radius	[mm]	20	25	35
Temperature di esercizio Working temperature	°C	-40...+100	-40...+100	-40...+100
Materiale anima Core material	Poliestere termoplastico Thermoplastic polyester			
Materiale treccia Braid material	Fibra aramidica Aramidic fibre "kevlar"			
Ricopertura est. Cover material	Poliuretano antiabrasione Antiabrasion polyurethane			



Raccordo connessione avvitabile per miniprese

Test coupling threaded female fitting

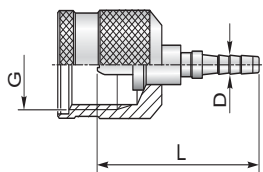

Tubo / Hose	G	L	PN [bar]	D	Codice/Ref.
RD2	M16x2	32.5	630	2.3	31TTN000
	M16x2	32.5	630	2.3	31TNAI00
	M16x1.5	32.5	630	2.3	31TTS000
	M12.65x1.5	32.5	400	2.3	31S12000
RD3	M16x2	32.5	630	3.0	31TTN003
	M16x1.5	32.5	630	3.0	31TTS003
	M12.65x1.5	32.5	400	3.0	31S12003
RD4	M16x2	36.5	630	4.2	31TTN004
	M16x1.5	36.5	630	4.2	31TTS004
	M12.65x1.5	36.5	400	4.2	31S12004

INOX / Stainless steel

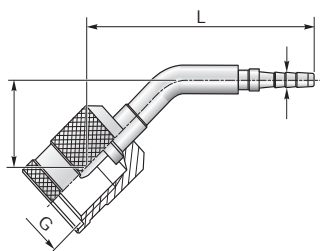

45°						
Tubo / Hose	G	L	H	PN [bar]	D	Codice/Ref.
RD2	M16x2	48	18.5	630	2.3	31TTN040
	M16x1.5	48	18.5	630	2.3	31TTS040
	M12.65x1.5	48	19	400	2.3	31S12040
RD3	M16x2	48	18.5	630	3.0	31TTN043
	M16x1.5	48	18.5	630	3.0	31TTS043
	M12.65x1.5	48	19	400	2.3	31S12043
RD4	M16x2	53	18.5	630	4.2	31TTN044
	M16x1.5	53	18.5	630	4.2	31TTS044
	M12.65x1.5	53	19	400	4.2	31S12044

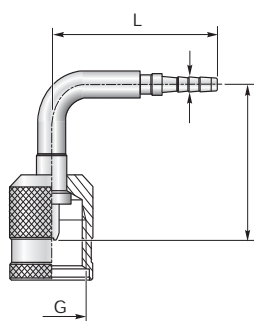

90°						
Tubo / Hose	G	L	H	PN [bar]	D	Codice/Ref.
RD2	M16x2	34.5	31.0	630	2.3	31TTN090
	M16x1.5	34.5	31.0	630	2.3	31TTS090
	M12.65x1.5	34	31.5	400	2.3	31S12090
RD3	M16x2	34.5	31.0	630	3.0	31TTN093
	M16x1.5	34.5	31.0	630	3.0	31TTS093
	M12.65x1.5	34	31.5	400	3.0	31S12093
RD4	M16x2	39.5	31.0	630	4.2	31TTN094
	M16x1.5	39.5	31.0	630	4.2	31TTS094
	M12.65x1.5	39	31.5	400	4.2	31S12094



Raccordo connessione avvitabile per miniprese con dado esagonale

Test coupling threaded female fitting with hexagonal nut

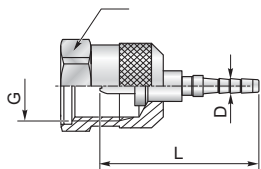

Tubo / Hose	G	L	Ch	PN [bar]	D	Codice/Ref.
RD2	M16x2	32.5	19	630	2.3	31TTN600
	M16x2	32.5	19	630	2.3	31TSAI00
	M16x1.5	32.5	19	630	2.3	31TTS600
RD3	M16x2	32.5	19	630	3.0	31TTN603
	M16x1.5	32.5	19	630	3.0	31TTS603
RD4	M16x2	36.5	19	630	4.2	31TTN604
	M16x1.5	36.5	19	630	4.2	31TTS604

INOX / Stainless steel

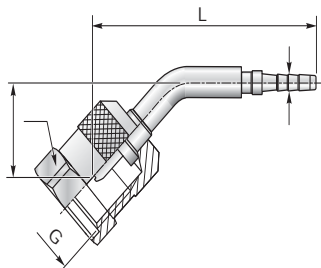

45°							
Tubo / Hose	G	L	H	Ch	PN [bar]	D	Codice/Ref.
RD2	M16x2	48	18.5	19	630	2.3	31TTN640
	M16x1.5	48	18.5	19	630	2.3	31TTS640
RD3	M16x2	48	18.5	19	630	3.0	31TTN643
	M16x1.5	48	18.5	19	630	3.0	31TTS643
RD4	M16x2	53	18.5	19	630	4.2	31TTN644
	M16x1.5	53	18.5	19	630	4.2	31TTS644

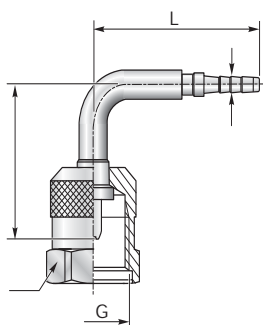

90°						
Tubo / Hose	G	L	H	PN [bar]	D	Codice/Ref.
RD2	M16x2	34.5	31	630	2.3	31TTN690
	M16x1.5	34.5	31	630	2.3	31TTS690
RD3	M16x2	34.5	31	630	3.0	31TTN693
	M16x1.5	34.5	31	630	3.0	31TTS693
RD4	M16x2	39.5	31	630	4.2	31TTN694
	M16x1.5	39.5	31	630	4.2	31TTS694



Raccordo connessione avvitabile per manometro

Gauges threaded fitting

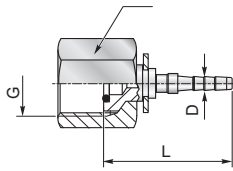

Tubo / Hose	G	L	Ch	PN [bar]	D	Codice/Ref.
RD2	G 1/4	26.5	17	630	2.3	36140000
	G 1/4	26.5	17	630	2.3	3614AI00
	G 1/2	31.5	27	630	2.3	36120000
RD3	M20X1.5	31.5	27	630	2.3	36M2OR00
	G 1/4	26.5	17	630	3.0	3614OR03
	G 1/2	31.5	27	630	3.0	3612OR03
RD4	M20X1.5	31.5	27	630	3.0	36M2OR03
	G 1/4	29.5	17	630	4.2	3614OR04
	G 1/2	36.5	27	630	4.2	3612OR04
	M20X1.5	36.5	27	630	4.2	36M2OR04

INOX / Stainless steel

45°

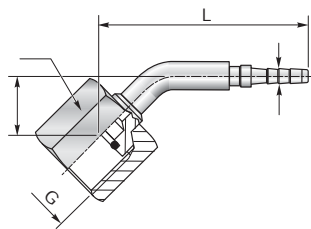

Tubo / Hose	G	H	L	Ch	PN [bar]	D	Codice/Ref.
RD2	G 1/4	14.0	47.0	17	630	2.3	36140040
	G 1/2	21.0	54.5	27	630	2.3	36120040
	M20X1.5	21.0	54.5	27	630	2.3	36M2OR40
RD3	G 1/4	14.0	47.0	17	630	3.0	3614OR43
	G 1/2	21.0	54.5	27	630	3.0	3612OR43
	M20X1.5	21.0	54.5	27	630	3.0	36M2OR43
RD4	G 1/4	14.0	52.0	17	630	4.2	3614OR44
	G 1/2	21.0	59.5	27	630	4.2	3612OR44
	M20X1.5	21.0	59.5	27	630	4.2	36M2OR44

90°

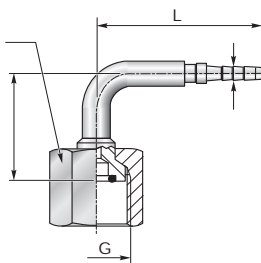

Tubo / Hose	G	H	L	Ch	PN [bar]	D	Codice/Ref.
RD2	G 1/4	25.0	38.0	17	630	2.3	36140090
	G 1/2	37.5	41.5	27	630	2.3	36120090
	M20X1.5	37.5	41.5	27	630	2.3	36M2OR90
RD3	G 1/4	25.0	38.0	17	630	3.0	3614OR93
	G 1/2	37.5	41.5	27	630	3.0	3612OR93
	M20X1.5	37.5	41.5	27	630	3.0	36M2OR93
RD4	G 1/4	25.0	43.0	17	630	4.2	3614OR94
	G 1/2	37.5	46.5	27	630	4.2	3612OR94
	M20X1.5	37.5	46.5	27	630	4.2	36M2OR94



Raccordo connessione avvitabile per manometro

Gauges threaded fitting

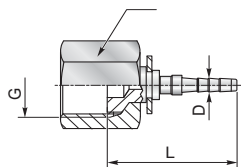

Tubo / Hose	G	L	Ch	PN [bar]	D	Codice/Ref.
RD2	G 1/4	26.5	17	400	2.3	3614CR00
	G 1/2	31.5	27	400	2.3	3612CR00
	M20X1.5	31.5	27	400	2.3	36M2CR00
RD3	G 1/4	26.5	17	400	3.0	3614CR03
	G 1/2	31.5	27	400	3.0	3612CR03
	M20X1.5	31.5	27	400	3.0	36M2CR03
RD4	G 1/4	29.5	17	400	4.2	3614CR04
	G 1/2	36.5	27	400	4.2	3612CR04
	M20X1.5	36.5	27	400	4.2	36M2CR04

45°

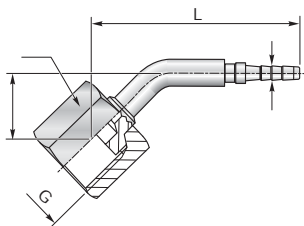

Tubo / Hose	G	H	L	Ch	PN [bar]	D	Codice/Ref.
RD2	G 1/4	14	47	17	400	2.3	3614CR40
	G 1/2	21	54.5	27	400	2.3	3612CR40
	M20X1.5	21	54.5	27	400	2.3	36M2CR40
RD3	G 1/4	14	47	17	400	3.0	3614CR43
	G 1/2	21	54.5	27	400	3.0	3612CR43
	M20X1.5	21	54.5	27	400	3.0	36M2CR43
RD4	G 1/4	14	52	17	400	4.2	3614CR44
	G 1/2	21	59.5	27	400	4.2	3612CR44
	M20X1.5	21	59.5	27	400	4.2	36M2CR44

90°

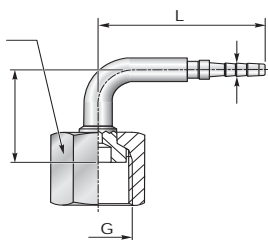

Tubo / Hose	G	H	L	Ch	PN [bar]	D	Codice/Ref.
RD2	G 1/4	25	38	17	400	2.3	3614CR90
	G 1/2	37.5	41.5	27	400	2.3	3612CR90
	M20X1.5	37.5	41.5	27	400	2.3	36M2CR90
RD3	G 1/4	25	38	17	400	3.0	3614CR93
	G 1/2	37.5	41.5	27	400	3.0	3612CR93
	M20X1.5	37.5	41.5	27	400	3.0	36M2CR93
RD4	G 1/4	25	43	17	400	4.2	3614CR94
	G 1/2	37.5	46.5	27	400	4.2	3612CR94
	M20X1.5	37.5	46.5	27	400	4.2	36M2CR94



Raccordo connessione avvitabile per manometro

Gauges threaded fitting

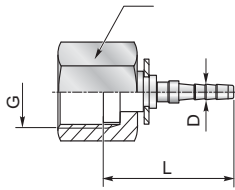

Tubo / Hose	G	L	Ch	PN [bar]	D	Codice/Ref.
RD2	G 1/8	2.3	—	—	2.3	4918DF00
	G 1/4	2.3	—	—	2.3	4914DF00
RD3	G 1/8	3.0	—	—	3.0	4918DF03
	G 1/4	3.0	—	—	3.0	4914DF03
RD4	G 1/8	4.2	—	—	4.2	4918DF04
	G 1/4	4.2	—	—	4.2	4914DF04

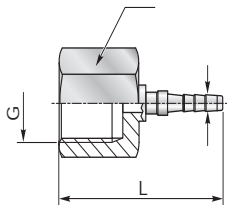

Tubo / Hose	G	L	Ch	PN [bar]	D	Codice/Ref.
RD2	1/4-18 NPTF	37	19	630	2.3	37140000
RD3	1/4-18 NPTF	37	19	630	3.0	37140003
RD4	1/4-18 NPTF	42	19	630	4.2	37140004

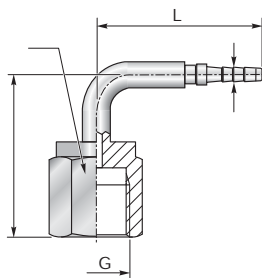

90°

Tubo / Hose	G	H	L	Ch	PN [bar]	D	Codice/Ref.
RD2	1/4-18 NPTF	38.5	31	19	630	2.3	37140090
RD3	1/4-18 NPTF	38.5	31	19	630	3.0	37140093
RD4	1/4-18 NPTF	38.5	36	19	630	4.2	37140094



Raccordo femmina girevole connessione cono 60° tipo DKR

Swivel female fitting 60° cone connection type DKR

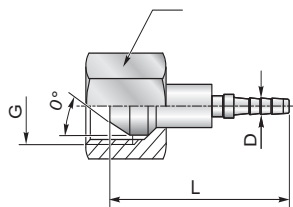

Tubo / Hose	G	L	Ch	D	Codice/Ref.
RD2	G 1/8	27.5	14	2.3	38180000
	G 1/4	29	17	2.3	38140000
	G 1/4	29	17	2.3	3814A100
RD3	G 1/8	27	14	3.3	38180003
	G 1/4	29	17	3.3	38140003
RD4	G 1/8	31	14	4.3	38180004
	G 1/4	32.5	17	4.3	38180004

INOX / Stainless steel

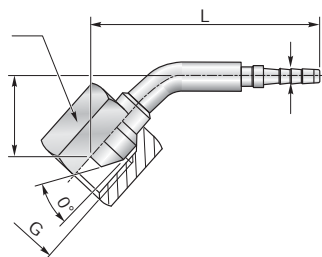

45°						
Tubo / Hose	G	H	L	Ch	D	Codice/Ref.
RD2	G 1/8	15	44.5	14	2.3	38180040
	G 1/4	16	47.5	17	2.3	38140040
RD3	G 1/8	15	44.5	14	3.3	38180043
	G 1/4	16	47.5	17	3.3	38140043
RD4	G 1/8	15	49.5	14	4.3	38180044
	G 1/4	16	52.5	17	4.3	38140044

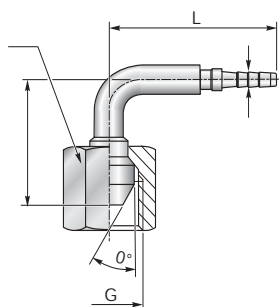

90°						
Tubo / Hose	G	H	L	Ch	D	Codice/Ref.
RD2	G 1/8	26	34	14	2.3	38180090
	G 1/4	27.5	36.5	17	2.3	38140090
RD3	G 1/8	26	34	14	3.3	38180093
	G 1/4	27.5	36.5	17	3.3	38140093
RD4	G 1/8	26	39	14	4.3	38180094
	G 1/4	27.5	41.5	17	4.3	38140094



Raccordo femmina girevole connessione cono 24° tipo DKL

Swivel female fitting 24° cone connection type DKL

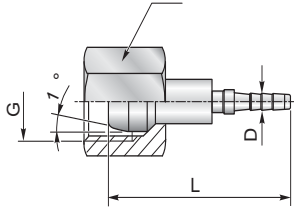

Tubo / Hose	Ø	G	L	Ch	D	Codice/Ref.
RD2	6	M12x1.5	—	14	2.3	45R00000
	8	M14x1.5	—	17	2.3	45R20000
	10	M16x1.5	—	19	2.3	45R50000
RD3	6	M12x1.5	—	14	3.3	45R00003
	8	M14x1.5	—	17	3.3	45R20003
	10	M16x1.5	—	19	3.3	45R50003
RD4	6	M12x1.5	—	14	4.3	45R00004
	8	M14x1.5	—	17	4.3	45R20004
	10	M16x1.5	—	19	4.3	45R50003

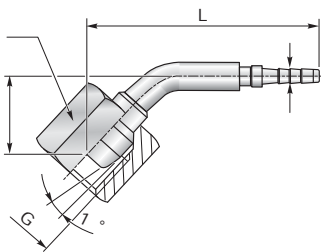

45°							
Tubo / Hose	Ø	G	H	L	Ch	D	Codice/Ref.
RD2	6	M12x1.5	—	—	14	2.3	45R00040
	8	M14x1.5	—	—	17	2.3	45R20040
	10	M16x1.5	—	—	19	2.3	45R50040
RD3	6	M12x1.5	—	—	14	3.3	45R00043
	8	M14x1.5	—	—	17	3.3	45R20043
	10	M16x1.5	—	—	19	3.3	45R50043
RD4	6	M12x1.5	—	—	14	4.3	45R00044
	8	M14x1.5	—	—	17	4.3	45R20044
	10	M16x1.5	—	—	19	4.3	45R50043

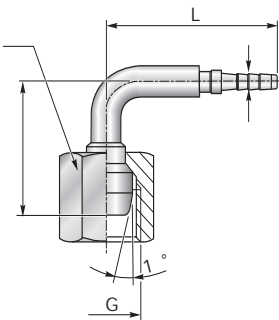

90°							
Tubo / Hose	Ø	G	H	L	Ch	D	Codice/Ref.
RD2	6	M12x1.5	—	—	14	2.3	45R00090
	8	M14x1.5	—	—	17	2.3	45R20090
	10	M16x1.5	—	—	19	2.3	45R50090
RD3	6	M12x1.5	—	—	14	3.3	45R00093
	8	M14x1.5	—	—	17	3.3	45R20093
	10	M16x1.5	—	—	19	3.3	45R50093
RD4	6	M12x1.5	—	—	14	4.3	45R00094
	8	M14x1.5	—	—	17	4.3	45R20094
	10	M16x1.5	—	—	19	4.3	45R50093



Raccordo femmina girevole connessione cono 24° tipo DKOL

Swivel female fitting 24° cone connection type DKOL

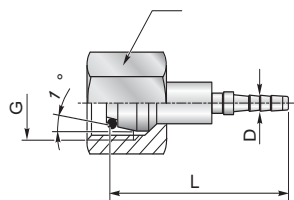

Tubo / Hose	Ø	G	L	Ch	D	Codice/Ref.
RD2	6	M12x1.5	35	14	2.3	35R00000
	8	M14x1.5	35	17	2.3	35R20000
	10	M16x1.5	36.5	19	2.3	35R50000
	12	M18x1.5	37.5	22	2.3	35R60000
RD3	6	M12x1.5	35	14	3.3	35R00003
	8	M14x1.5	35	17	3.3	35R20003
	10	M16x1.5	36.5	19	3.3	35R50003
RD4	6	M12x1.5	36	14	4.3	35R00004
	8	M14x1.5	36	17	4.3	35R20004
	10	M16x1.5	41.5	19	4.3	35R50003
	12	M18x1.5	42.5	22	4.3	35R60004

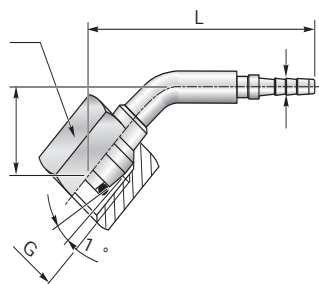

45°							
Tubo / Hose	Ø	G	H	L	Ch	D	Codice/Ref.
RD2	6	M12x1.5	19.5	53.5	14	2.3	35R00040
	8	M14x1.5	19	51	17	2.3	35R20040
	10	M16x1.5	22.5	56	19	2.3	35R50040
RD3	12	M12x1.5	19.5	53.5	14	3.3	35R00043
	6	M14x1.5	19	51	17	3.3	35R20043
	8	M16x1.5	22.5	56	19	3.3	35R50043
RD4	10	M12x1.5	19.5	58.5	14	4.3	35R00044
	6	M14x1.5	19	56	17	4.3	35R20044
	8	M16x1.5	22.5	61	19	4.3	35R50043
	10	M18x1.5	—	—	22	4.3	35R60044

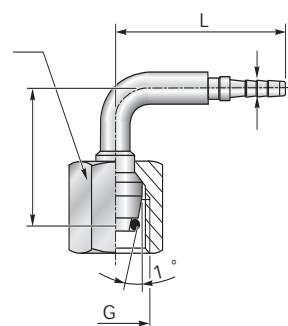

90°							
Tubo / Hose	Ø	G	H	L	Ch	D	Codice/Ref.
RD2	6	M12x1.5	36	42	14	2.3	35R00090
	8	M14x1.5	36	40.5	17	2.3	35R20090
	10	M16x1.5	40	41.5	19	2.3	35R50090
RD3	12	M12x1.5	36	42	14	3.3	35R00093
	6	M14x1.5	36	40.5	17	3.3	35R20093
RD4	8	M16x1.5	40	41.5	19	3.3	35R50093
	10	M12x1.5	36	47	14	4.3	35R00094
	6	M14x1.5	36	45.5	17	4.3	35R20094
	8	M16x1.5	40	46.5	19	4.3	35R50093
	10	M18x1.5	—	—	22	4.3	35R60094



Raccordo femmina girevole connessione cono 24° tipo DKOLL

Swivel female fitting 24° cone connection type DKOLL

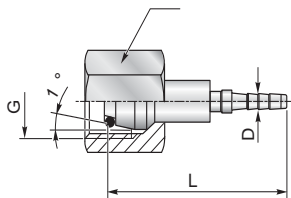

Tubo / Hose	Ø	G	L	Ch	D	Codice/Ref.
RD2	4	M8x1	29.5	10	2.3	46R00000
	6	M10x1	30.5	12	2.3	46R10000
RD3	4	M8x1	29.5	10	3.0	46R00003
	6	M10x1	30	12	3.0	46R10003
RD4	4	M8x1	29.5	10	4.2	46R00004
	6	M10x1	33.5	12	4.2	46R10004

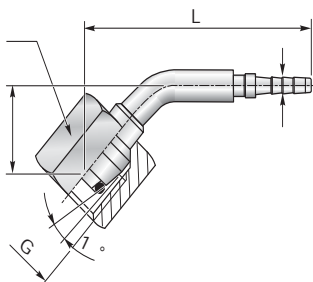

45°

Tubo / Hose	Ø	G	H	L	Ch	D	Codice/Ref.
RD2	6	M10x1	14	43	12	2.3	46R10040
RD3	6	M10x1	14	43	12	3.3	46R10043
RD4	6	M10x1	14	48	12	4.3	46R10044

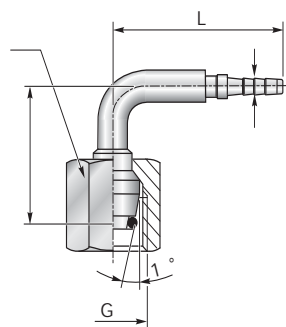

90°

Tubo / Hose	Ø	G	H	L	Ch	D	Codice/Ref.
RD2	6	M10x1	24.5	33.5	12	2.3	46R10090
RD3	6	M10x1	24.5	33.5	12	3.3	46R10093
RD4	6	M10x1	24.5	38.5	12	4.3	46R10094



Raccordo femmina girevole connessione cono 24° tipo DKOS

Swivel female fitting 24° cone connection type DKOS

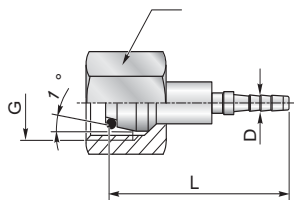

Tubo / Hose	Ø	G	L	Ch	D	Codice/Ref.
RD2	6	M14x1.5	35	17	2.3	35R10000
	8	M16x1.5	35	19	2.3	35R30000
	10	M18x1.5	36.5	22	2.3	35R40000
	12	M20x1.5	37.5	24	2.3	35R70000
RD3	6	M14x1.5	35	17	3.3	35R10003
	8	M16x1.5	35	19	3.3	35R30003
	10	M18x1.5	36.5	22	3.3	35R40003
RD4	6	M14x1.5	36	17	4.3	35R10004
	8	M16x1.5	36	19	4.3	35R30004
	10	M18x1.5	41.5	22	4.3	35R40003

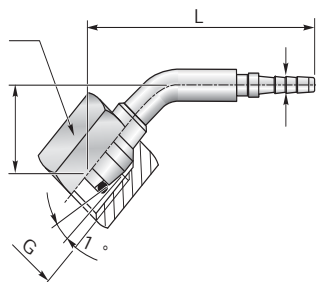

45°							
Tubo / Hose	Ø	G	H	L	Ch	D	Codice/Ref.
RD2	6	M14x1.5	19.5	53.5	17	2.3	35R10040
	8	M16x1.5	19	51	19	2.3	35R30040
	10	M18x1.5	22.5	56	22	2.3	35R40040
RD3	6	M14x1.5	19.5	53.5	17	3.3	35R10043
	8	M16x1.5	19	51	19	3.3	35R30043
	10	M18x1.5	22.5	56	22	3.3	35R40043
RD4	6	M14x1.5	19.5	58.5	17	4.3	35R10044
	8	M16x1.5	19	56	19	4.3	35R30044
	10	M18x1.5	22.5	61	22	4.3	35R40043
	12	M20x1.5	—	—	24	4.3	35R70044

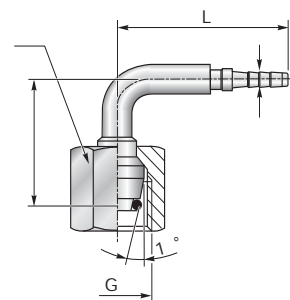

90°							
Tubo / Hose	Ø	G	H	L	Ch	D	Codice/Ref.
RD2	6	M14x1.5	36	42	17	2.3	35R10090
	8	M16x1.5	36	40.5	19	2.3	35R30090
	10	M18x1.5	40	41.5	22	2.3	35R40090
RD3	6	M14x1.5	36	42	17	3.3	35R10093
	8	M16x1.5	36	40.5	19	3.3	35R30093
	10	M18x1.5	40	41.5	22	3.3	35R40093
RD4	6	M14x1.5	36	47	17	4.3	35R10094
	8	M16x1.5	36	45.5	19	4.3	35R30094
	10	M18x1.5	40	46.5	22	4.3	35R40093
	12	M20x1.5	—	—	24	4.3	35R70094



Raccordo femmina girevole connessione JIC 74° tipo DKJ

Swivel female fitting JIC 74° connection type DKJ

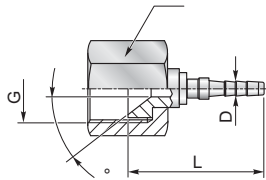

Tubo / Hose	G	L	Ch	PN [bar]	D	Codice/Ref.
RD2	7/16-20 UNF	25	14	310	2.3	39160000
	1/2-20 UNF	28.5	17	275	2.3	39120000
	3/8-24 UNF	24.5	12	345	2.3	3938J000
	9/16-18 UNF	28.5	19	275	2.3	3991J000
RD3	7/16-20 UNF	25	14	310	3.3	39160003
	1/2-20 UNF	28.5	17	275	3.3	39120003
	3/8-24 UNF	24.5	12	345	3.3	3938J003
RD4	7/16-20 UNF	28	14	310	4.3	39160004
	1/2-20 UNF	31.5	17	275	4.3	39120004
	3/8-24 UNF	28.5	12	345	4.3	3938J004

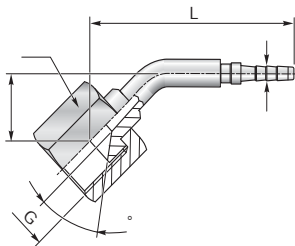

45°

Tubo / Hose	G	H	L	Ch	PN [bar]	D	Codice/Ref.
RD2	7/16-20 UNF	13	46.5	14	310	2.3	39160040
	1/2-20 UNF	—	—	17	275	2.3	39120040
	3/8-24 UNF	—	—	12	345	2.3	3938J040
RD3	7/16-20 UNF	13	46.5	14	310	3.3	39160043
	1/2-20 UNF	—	—	17	275	3.3	39120043
	3/8-24 UNF	—	—	12	345	3.3	3938J043
RD4	7/16-20 UNF	13	51.5	14	310	4.3	39160044
	1/2-20 UNF	—	—	17	275	4.3	39120044
	3/8-24 UNF	—	—	12	345	4.3	3938J044

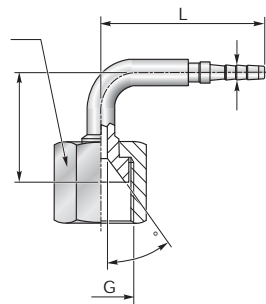

90°

Tubo / Hose	G	H	L	Ch	PN [bar]	D	Codice/Ref.
RD2	7/16-20 UNF	23	38.5	14	310	2.3	39160090
	1/2-20 UNF	—	—	17	275	2.3	39120090
	3/8-24 UNF	—	—	12	345	2.3	3938J090
RD3	7/16-20 UNF	13	46.5	14	310	3.3	39160093
	1/2-20 UNF	—	—	17	275	3.3	39120093
	3/8-24 UNF	—	—	12	345	3.3	3938J093
RD4	7/16-20 UNF	23	43.5	14	310	4.3	39160094
	1/2-20 UNF	—	—	17	275	4.3	39120094
	3/8-24 UNF	—	—	12	345	4.3	3938J094



Raccordi a codolo liscio

Standpipe fitting

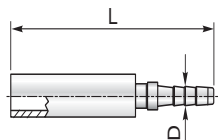

Tubo / Hose	Ø	L	D	Codice/Ref.
RD2	4	36	2.3	34R70000
	6	36	2.3	34R00000
	8	37.5	2.3	34R30000
RD3	4	36	3.3	34R70003
	6	36	3.3	34R00003
	8	37.5	3.3	34R30003
RD4	4	41	4.3	34R70004
	6	41	4.3	34R00004
	8	41	4.3	34R30004

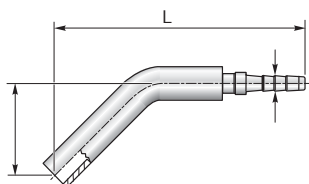

45°					
Tubo / Hose	Ø	H	L	D	Codice/Ref.
RD2	4	14.5	43	2.3	34R70040
	6	16.5	44	2.3	34R00040
	8	20	52	2.3	34R30040
RD3	4	14.5	43	3.3	34R70043
	6	16.5	44	3.3	34R00043
	8	20	52	3.3	34R30043
RD4	4	14.5	48	4.3	34R70044
	6	16.5	49	4.3	34R00044
	8	20	57	4.3	34R30044

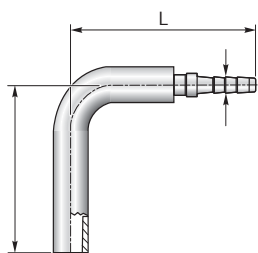

90°					
Tubo / Hose	Ø	H	L	D	Codice/Ref.
RD2	4	25.5	33	2.3	34R70090
	6	28	32	2.3	34R00090
	8	37	41	2.3	34R30090
RD3	4	25.5	33	3.3	34R70093
	6	28	32	3.3	34R00093
	8	37	41	3.3	34R30093
RD4	4	25.5	38	4.3	34R70094
	6	28	37	4.3	34R00094
	8	37	46	4.3	34R30094



Raccordi ad occhio e a dado forato
Banjo fitting and banjo screw

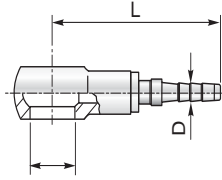

Tubo / Hose	d	L	D	Codice/Ref.
RD2	8	29.5	2.3	42R10000
	10	31.5	2.3	42R00000
RD3	8	29.5	3.3	42R10003
	10	31.5	3.3	42R00003
RD4	8	34.5	4.3	42R10004
	10	36.5	4.3	42R00004
	14	40.5	4.3	42R20004

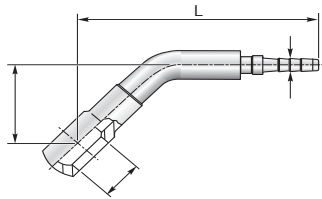

45°					
Tubo / Hose	d	H	L	D	Codice/Ref.
RD2	8	15	46.5	2.3	42R10000
	10	23.5	51	2.3	42R00000
RD3	8	15	46.5	3.3	42R10003
	10	23.5	51	3.3	42R00003
RD4	8	15	51.5	4.3	42R10004
	10	23.5	56	4.3	42R00004

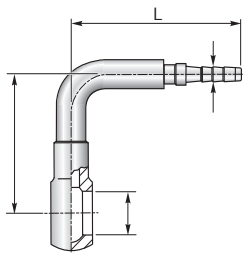

90°					
Tubo / Hose	d	H	L	D	Codice/Ref.
RD2	8	26	36	2.3	42R10090
	10	38	32	2.3	42R00090
RD3	8	26	36	3.3	42R10093
	10	38	32	3.3	42R00093
RD4	8	26	41	4.3	42R10094
	10	38	37	4.3	42R00094

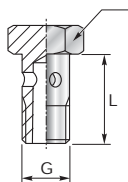

G	L	Ch	Codice/Ref.
M8x1	17	12	42R0HS00
M10x1	19	14	42R1HS00
G1/8	19	14	4218HS00



Raccordi maschio fisso

Male fittings

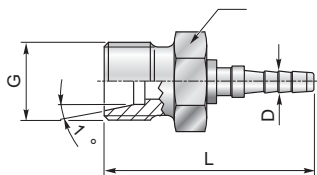

Tubo / Hose	G	L	Ch	D	Codice/Ref.
RD2	M12x1.5	31.5	12	2.3	44MFLR00
	M14x1.5	31.5	14	2.3	44MFLR10
	M16x1.5	32.5	17	2.3	44MFLR30
RD3	M12x1.5	31.5	12	3.3	44MFLR03
	M14x1.5	31.5	14	3.3	44MFLR13
	M16x1.5	32.5	17	3.3	44MFLR33
RD4	M12x1.5	36.5	12	4.3	44MFLR04
	M14x1.5	36.5	14	4.3	44MFLR14
	M16x1.5	37.5	17	4.3	44MFLR34

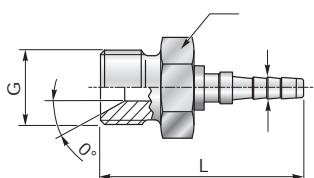

Tubo / Hose	G	L	Ch	D	Codice/Ref.
RD2	G 1/8	33.5	14	2.3	44MFG180
	G 3/8	36	19	2.3	44MFG140
RD3	G 1/8	33.5	14	3.3	44MFG183
	G 3/8	36	19	3.3	44MFG143
RD4	G 1/8	38.5	14	4.3	44MFG184
	G 3/8	41	19	4.3	44MFG144

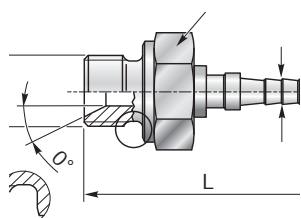

Tubo / Hose	G	L	Ch	D	Codice/Ref.
RD2	G 1/8	30	14	2.3	44MFM180
	G 1/4	35.5	19	2.3	44MFM140
RD3	G 1/8	30	14	3.3	44MFM183
	G 1/4	35.5	19	3.3	44MFM143
RD4	G 1/8	35	14	4.3	44MFM184
	G 1/4	40.5	19	4.3	44MFM144

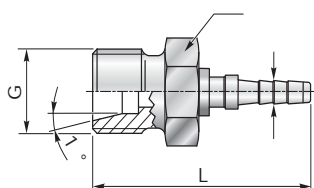

Tubo / Hose	G	L	Ch	D	Codice/Ref.
RD2	M14x1.5	33.5	14	2.3	44MFSR00
	M16x1.5	33.5	17	2.3	44MFSR10
	M18x1.5	35	19	2.3	44MFSR20
RD3	M14x1.5	33.5	14	3.3	44MFSR03
	M16x1.5	33.5	17	3.3	44MFSR13
	M18x1.5	35	19	3.3	44MFSR23
RD4	M14x1.5	38.5	14	4.3	44MFSR04
	M16x1.5	38.5	17	4.3	44MFSR14
	M18x1.5	40	19	4.3	44MFSR24
	M20x1.5	40.5	22	4.3	44MFSR34



Raccordi maschio fisso

Male fittings

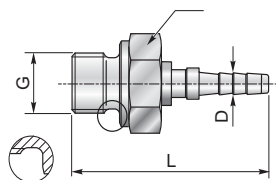

Tubo / Hose	G	L	Ch	D	Codice/Ref.
RD2	M8x1	—	12	2.3	44MFDR00
	M10x1	—	14	2.3	44MFDR10
	M12x1.5	—	17	2.3	44MFDR30
RD3	M8x1	—	12	3.3	44MFDR03
	M10x1	—	14	3.3	44MFDR13
	M12x1.5	—	17	3.3	44MFDR33
RD4	M8x1	—	12	4.3	44MFDR04
	M10x1	—	14	4.3	44MFDR14
	M12x1.5	—	17	4.3	44MFDR34

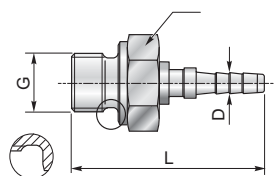

Tubo / Hose	G	L	Ch	D	Codice/Ref.
RD2	G 1/8	30	14	2.3	44MFD180
	G 1/4	35.5	19	2.3	44MFD140
RD3	G 1/8	30	14	3.3	44MFD183
	G 1/4	35.5	19	3.3	44MFD143
RD4	G 1/8	35	14	4.3	44MFD184
	G 1/4	40.5	19	4.3	44MFD144

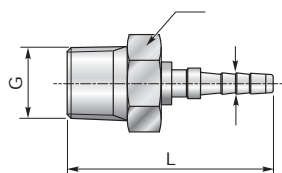

Tubo / Hose	G	L	Ch	D	Codice/Ref.
RD2	R 1/8	28	12	2.3	44MFC180
	R 1/4	33	14	2.3	44MFC140
RD3	R 1/8	28	12	3.3	44MFC183
	R 1/4	33	14	3.3	44MFC143
RD4	R 1/8	33	12	4.3	44MFC184
	R 1/4	38	14	4.3	44MFC144

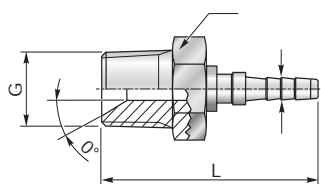

Tubo / Hose	G	L	Ch	D	Codice/Ref.
RD2	1/8-27 NPTF	30	12	2.3	44MF8000
	1/4-18 NPTF	35.5	17	2.3	44MF0000
RD3	1/8-27 NPTF	30	12	3.3	44MF8003
	1/4-18 NPTF	35.5	17	3.3	44MF0003
RD4	1/8-27 NPTF	35	12	4.3	44MF8004
	1/4-18 NPTF	40.5	17	4.3	44MF0004



Raccordi maschio JIC 74°

JIC 74° Male fittings

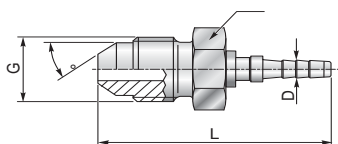

Tubo / Hose	G	L	Ch	D	Codice/Ref.
RD2	3/8-28 UNF	34	12	2.3	44AJ3800
	7/16-20 UNF	34.5	12	2.3	44AJ7100
	1/2-20 UNF	36	14	2.3	44AJ1200
RD3	3/8-24 UNF	34	12	3.3	44AJ3803
	7/16-20 UNF	34.5	12	3.3	44AJ7103
	1/2-20 UNF	36	14	3.3	44AJ1203
RD4	3/8-24 UNF	39	12	4.3	44AJ3804
	7/16-20 UNF	39.5	12	4.3	44AJ7104
	1/2-20 UNF	41	14	4.3	44AJ1204

Raccordi maschio 115°

115° Male fittings

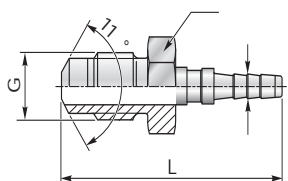

Tubo / Hose	G	L	Ch	D	Codice/Ref.
RD2	M6	37	8	2.3	4AM0600
	M8x1	32	10	2.3	4AM0800
RD3	M6	37	8	3.0	4AM0603
	M8x1	32	10	3.0	4AM0803



Innesto per minipressa a baionetta

Plug-in connection

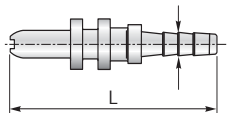

Tubo / Hose	L	PN [bar]	D	Codice/Ref.
RD2	27	400	2.3	33TD0000
RD3	27	400	3.0	33TD0003
RD4	32	400	4.2	33TD0004

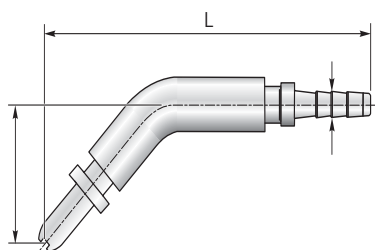

45°					
Tubo / Hose	H	L	PN [bar]	D	Codice/Ref.
RD2	24	55	400	2.3	33TD0040
RD3	24	55	400	3.0	33TD0043
RD4	24	60	400	4.2	33TD0044

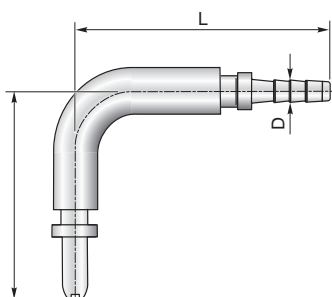

90°					
Tubo / Hose	H	L	PN [bar]	D	Codice/Ref.
RD2	41	32	400	2.3	33TD0090
RD3	41	32	400	3.0	33TD0093
RD4	41	37	400	4.2	33TD0094



Raccordo femmina tipo ORFS

ORFS female fitting, UNF thread

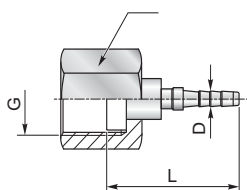

Tubo / Hose	G	L	Ch	PN [bar]	D	Codice/Ref.
RD2	9/16-18 UNF	25	17	413	2.3	5991F000
RD3	9/16-18 UNF	25	17	413	3.0	5991F003
RD4	9/16-18 UNF	28	17	413	4.2	5991F004

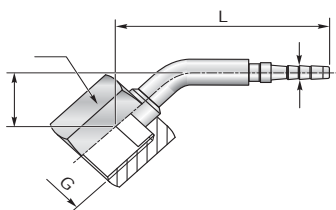

45°							
Tubo / Hose	G	H	L	Ch	PN [bar]	D	Codice/Ref.
RD2	9/16-18 UNF	13	47	17	413	2.3	5991F040
RD3	9/16-18 UNF	13	47	17	413	3.0	5991F043
RD4	9/16-18 UNF	13	52	17	413	4.2	5991F044

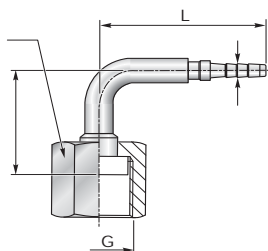

90°							
Tubo / Hose	G	H	L	Ch	PN [bar]	D	Codice/Ref.
RD2	9/16-18 UNF	23.5	39	17	413	2.3	5991F090
RD3	9/16-18 UNF	23.5	39	17	413	3.0	5991F093
RD4	9/16-18 UNF	23.5	44	17	413	4.2	5991F094

Raccordo maschio tipo ORFS

ORFS male fitting, UNF thread

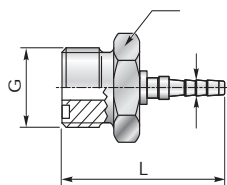

Tubo / Hose	G	L	PN [bar]	D	Codice/Ref.
RD2	9/16-18 UNF	—	413	2.3	5991M000
RD3	9/16-18 UNF	—	413	3.0	5991M003
RD4	9/16-18 UNF	—	413	4.2	5991M004

Ghiera a pressare

Ferrule

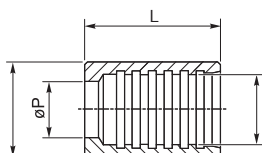

DA	DI	L	Ø P	PN [bar]	Codice/Ref.
8.0	5.1	14	7.1	600	30BT2000
8.0	5.1	14	7.1	600	30BTAI00
9.0	6.6	14	7.6	600	30BT3000
11.5	8.4	17	10.2	600	30BT4000

INOX / Stainless steel

Ø P= Diametro di pressature / crimping diameters



Le valigette prova pressione sono predisposte per il collegamento tramite raccordi avvitabili standard M 16x2 e tubo capillare flessibile.

I manometri sono a molla Bourdon con riempimento di liquido (glicerina 99.7%).

Classe di precisione (sul valore di fondo scala): 1% per i manometri diam. 100 mm e 1.6% per i manometri diam. 63 mm secondo NORMA DIN 16005.

Per ogni valigetta è possibile scegliere il fondo scala di ogni singolo manometro da includere all'interno della stessa. Ogni kit è corredato di tubo capillare flessibile Rapid System di mt 2.

Scale disponibili: -1...0 - 0,6 - 1 - 1,6 - 2,5 - 4 - 6 - 10 - 16 - 25 - 40 - 60 - 100 - 160 - 250 - 315 - 400 - 600 - 1000.

Test kits are made for connecting any hydraulic equipment with standard threaded test couplings M 16x2 and fitted micro-hose.

Pressure gauges are fitted with a Bourdon spring and liquid filled (glycerine 99.7%), according to DIN 16005.

*Ø 100 mm accuracy 1%.
 Ø 63 mm accuracy 1.6%.*

Each kit is supplied with a 2 metre micro hose and gauges chosen from these ranges, in bar:

- 1..0 - 0,6 - 1 - 1,6 - 2,5 - 4 - 6 - 10 - 16 - 25 - 40 - 60 - 100 - 160 - 250 - 315 - 400 - 600 - 1000.



3 manometri cassa inox

3 pressure gauges stainless steel housing

diam. 63 mm
 dim. 320x280xh119 mm

Codice/Ref.
CBOXMED3

4 manometri cassa inox

4 pressure gauges stainless steel housing

diam. 63 mm
 dim. 320x280xh119 mm

Codice/Ref.
CBOXMED4





5 manometri cassa ottone

5 pressure gauges brass housing

2 diam. 100 mm
3 diam. 63 mm
dim. 430x320xh120 mm

Codice/Ref.
CBOXGRA5

7 manometri cassa inox

7 pressure gauges stainless steel housing

diam. 63 mm
dim. 430x320xh120 mm

Codice/Ref.
CBOXGRA7



Kit portatile prova pressione componibile

Modular portable pressure test kit

diam. 63 mm
dim. 320x280xh119 mm

Codice/Ref.
CBOXMEDF





Manometri cassa acciaio inox con riempimento glicerina

Pressure gauges stainless steel case. Glycerine filled

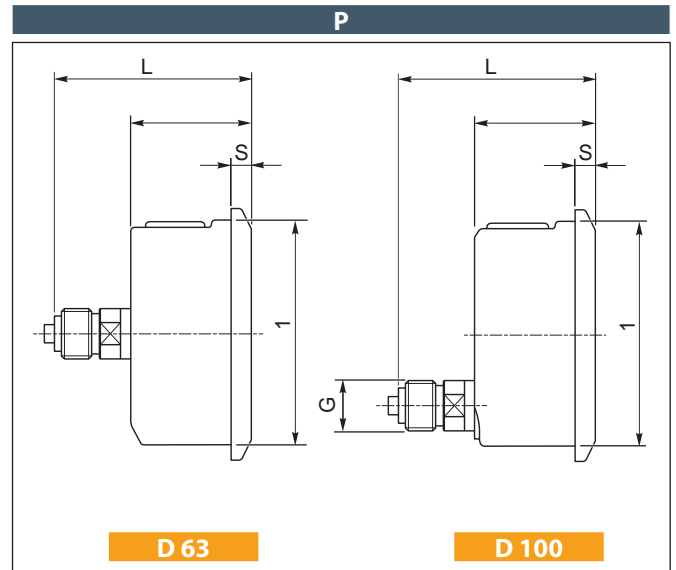
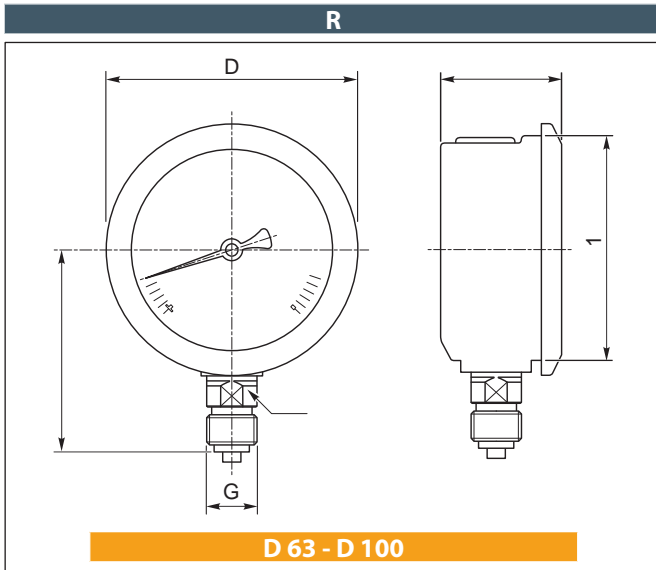

	D	G DIN 16228	H	H1	L mm	S mm	C mm	Ch mm	KI % F.S
D 63	63	G 1/4" A	54	62	56	6.5	32	14	1.6
D 100	100	G 1/2" B	87	100	81.5	8	48	22	1

D 63		
Scala / Range [bar]	Codice/Ref.	
-1...0	063.V01R	063.V01P
0...0.6	063.V06R	063.V06P
0...1	063.001R	063.001P
0...1.6	063.V16R	063.V16P
0...2.5	063.V25R	063.V25P
0...4	063.004R	063.004P
0...6	063.006R	063.006P
0...10	063.010R	063.010P
0...16	063.016R	063.016P
0...25	063.025R	063.025P
0...40	063.040R	063.040P
0...60	063.060R	063.060P
0...100	063.100R	063.100P
0...160	063.160R	063.160P
0...250	063.250R	063.250P
0...315	063.315R	063.315P
0...400	063.400R	063.400P
0...600	063.600R	063.600P
0...1000	063.M00R	063.M00P

D 100		
Scala / Range [bar]	Codice/Ref.	
-1...0	100.V01R	100.V01P
0...0.6	100.V06R	100.V06P
0...1	100.001R	100.001P
0...1.6	100.V16R	100.V16P
0...2.5	100.V25R	100.V25P
0...4	100.004R	100.004P
0...6	100.006R	100.006P
0...10	100.010R	100.010P
0...16	100.016R	100.016P
0...25	100.025R	100.025P
0...40	100.040R	100.040P
0...60	100.060R	100.060P
0...100	100.100R	100.100P
0...160	100.160R	100.160P
0...250	100.250R	100.250P
0...315	100.315R	100.315P
0...400	100.400R	100.400P
0...600	100.600R	100.600P
0...1000	100.M00R	100.M00P



Esclusore attacco diretto girevole

Anti-shock valve swivel straight connection

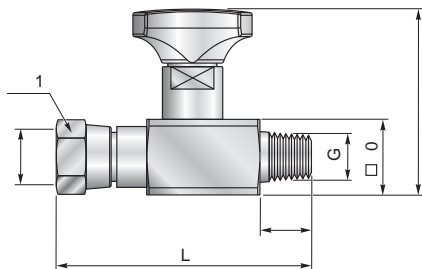

G	g	H	L	l	PN [bar]	Codice/Ref.
ISO 7/1 R 1/4"	ISO 228 G1/4"	50	60	14	400	ES 180

Esclusore attacco diretto doppia femmina girevole

Anti-shock valve double swivel straight connection

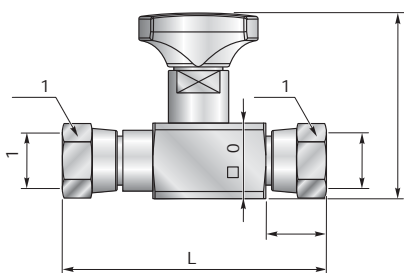

g1	g2	H	L	l	PN [bar]	Codice/Ref.
ISO 228 G1/4"	ISO 228 G1/4"	50	60	14	400	ES 18G

Esclusore attacco diretto fisso

Anti-shock valve fixed straight connection

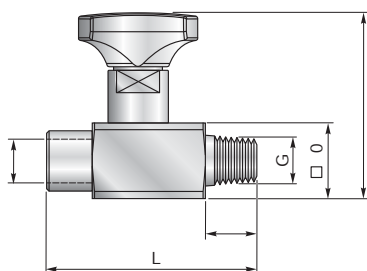

G	g	H	L	l	PN [bar]	Codice/Ref.
ISO 7/1 R 1/4"	ISO 228 G1/4"	50	58	14	400	ES 18F



Esclusore attacco 90°

Anti-shock valve 90° connection

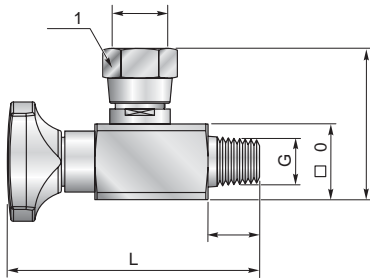

G	g	H	L	I	PN [bar]	Codice/Ref.
ISO 7/1 R 1/4"	ISO 228 G1/4"	40	68	14	400	ES 090

Esclusore attacco 90° doppia femmina girevole

Anti-shock valve 90° double swivel connection

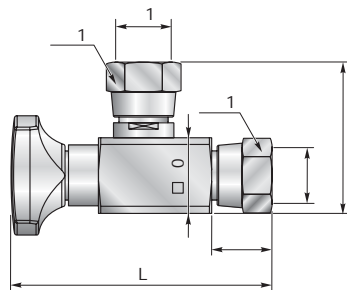

g1	g2	H	L	I	PN [bar]	Codice/Ref.
ISO 228 G1/4"	ISO 228 G1/4"	40	68	14	400	ES 09G

Esclusore attacco fisso 90°

Anti-shock valve fixed 90° connection

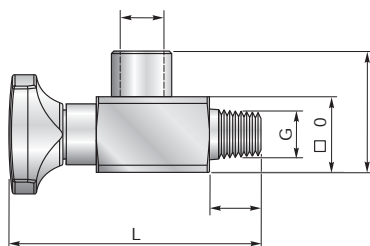

G	g	H	L	I	PN [bar]	Codice/Ref.
ISO 7/1 R 1/4"	ISO 228 G1/4"	40	68	14	400	ES 09F



Gamma / Range	Caratteristiche / Features
16 LPM 30 LPM 60 LPM 120 LPM 180 LPM	Pressione 420 bar (6000 psi) / Pressure 420 bar (6000 psi) Classe di precisione 4% fsd / Accuracy within 4% fsd
200 LPM 300 LPM 400 LPM	Pressione 280 bar (4000 psi) / Pressure 280 bar (4000 psi) Classe di precisione 4% fsd / Accuracy within 4% fsd

I misuratori di portata sono progettati per rilevazioni continue o uso discontinuo.

L'ampio diametro di 63mm dello strumento di lettura analogico assicura controlli rapidi per monitorare le prestazioni di pompe idrauliche e per settare valvole di controllo del flusso.

Possono essere utilizzati su impianti idraulici fissi e mobili, ma anche su sistemi di lubrificazione e raffreddamento e su equipaggiamenti per l'erogazione di acqua e acqua-olio.

Per le loro caratteristiche i misuratori di portata possono essere utilizzati in condizioni avverse o in applicazioni dove non è possibile attingere all'energia elettrica.

Inoltre è possibile misurare la temperatura, tramite il termometro e la pressione, grazie alla predisposizione per la connessione con una minipresa da 1/4" G.

Flow indicators are designed for continuous monitoring or intermittent use commissioning.

The large clear 63mm diameter dial ensure that quick checks can be made to determine pump performance and setting of flow control valves.

They can be used on mobile and industrial hydraulic circuits. Also lubrication and coolant system using oil/water.

These direct acting flow indicators can be installed in hazardous areas or on applications where no power is available.

Moreover it is possible to check the temperature by the thermometer and the pressure by the predisposition for the connection with a 1/4" G test coupling.



Pressa tubi manuale / Manual hydraulic press



Pressa tubi automatica / Automatic hydraulic press



- La pressa è stata dimensionata per un' esecuzione molto precisa di pressature di piccoli diametri, partendo dal tubo capillare tipo Rapid System fino a pressature di 1/2".
- Particolarmente adatta per tubi con diametro esterno 5 - 5.5 - 5.9 mm - 1/8" - 4x8" - 3/16" - 1/4".
- Forza di pressatura 56 tonnellate con pressione di esercizio di 500 bar.
- Disponibili 3 serie di morsetti di diametro 6.5 - 10 - 14 mm.
- Dimensioni: 267 x 300 x h 237 mm (+95mm di ingombro micrometro).
- Peso: Kg 15.
- Azionamento: la pressa è dotata di una pompa da 700 bar per l'azionamento manuale.
- Per aumentare la produttività si può passare rapidamente ad un azionamento automatico tramite un innesto rapido che, posto nella base, permette di collegare un moltiplicatore di pressione aria / olio (come nelle foto), oppure una qualsiasi centralina oleodinamica.

- The press machine is suitable for a high precision pressing of low hose diameter, starting from the micro hose Rapid System till pressing for 1/2".
- Particularly suitable for hose with a external diameter of 5 - 5.5 - 5.9 mm - 1/8" - 4/8" - 3/16" - 1/4".
- Pressing force of 56 ton with working pressure of 500 bar.
- Available 3 type of clamps, diameter 6.5 - 10 - 14 mm.
- Measures: 267 x 300 x 237 mm (+95 mm for the micrometer).
- Weight Kg 15.
- Operation: the hydraulic press machine is provided with a 700 bar pump suitable for the manual operation.
- In order to increase the productivity of the machine, is possible to have an automatic operation with an enclosed quick coupling on which is possible to connect to a pressing multiplier air / fluid (as in the picture), or to connect to a every hydraulic power pak.



MINIPRESS s.r.l.

40050 CASTELLO D'ARCILE (BO) - ITALY . VIA L. EINAUDI, 11

TEL. +39.051.6869070 . FAX +39.051.977842 . INFO@MINIPRESS.IT . WWW.MINIPRESS.IT